

Synchronous telescopic spindle unit 4115.14

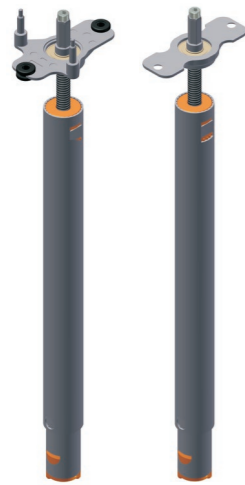

Description

Twofold telescopic lifting unit with bevel gear head for various linear drive solutions. Ideal for electromotive sit-stand workplace applications or wherever an infinite linear adjustment is required at a high speed, maximum stroke with a minimum installation dimension. The lifting unit is available in different spindle lengths.

Special features

- Double speed through synchronous telescope design
- Maximum stroke with minimum installation dimension
- Ideal for electromotive drives
- Available in different spindle lengths

Variant key

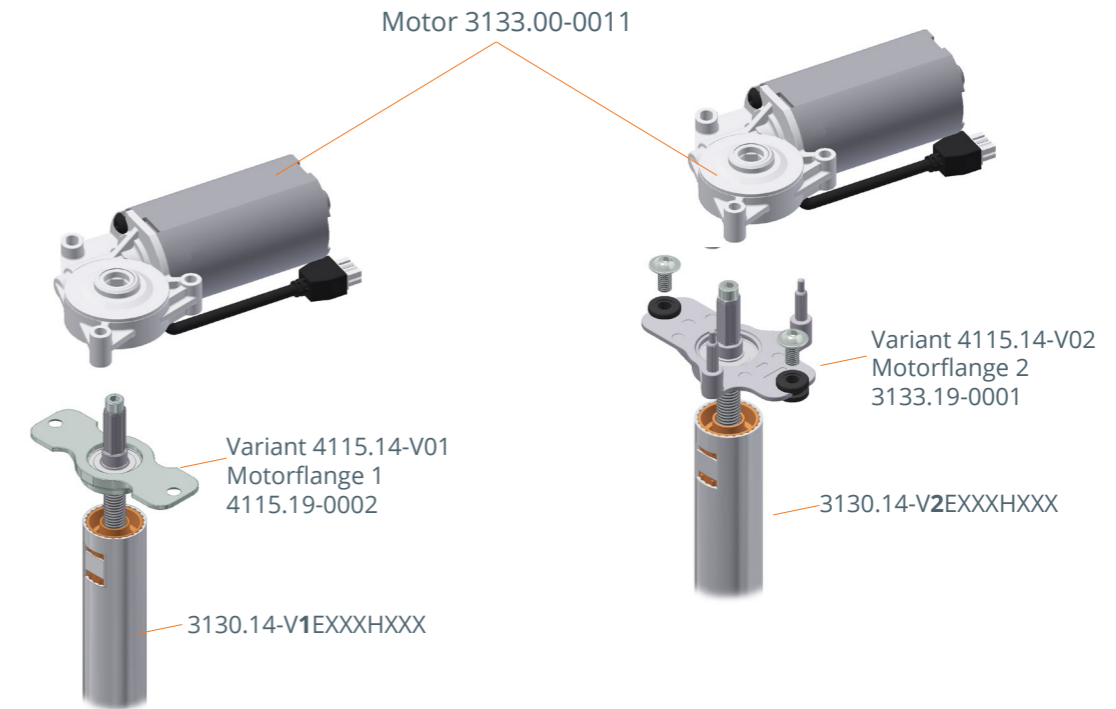
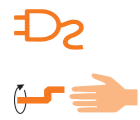
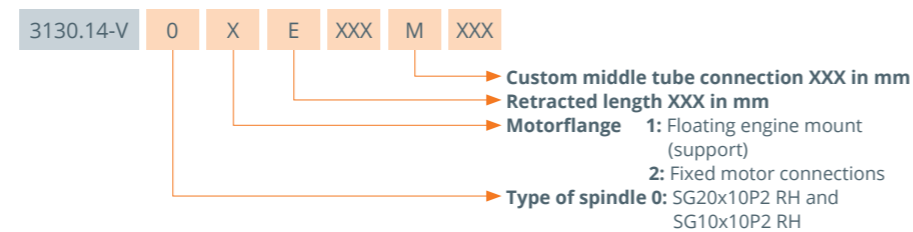

Technical data

Model	4115.14-V02EXXXMXXX	4115.14-V01EXXXMXXX
Type of spindle	SG20x10P2 RH SG10x10P2 RH	SG20x10P2 RH SG10x10P2 RH
Travel path	20 mm/rotation synchronous spindle movement	20 mm/rotation synchronous spindle movement
Traverse speed*	40 mm/s*	40 mm/s*
Retracted length E	customized min. 476 mm, max. 560 mm	customized min. 476 mm, max. 560 mm
Stroke H**	720 mm	720 mm
Max. lifting force	dyn. 900 N stat. 900 N	dyn. 900 N stat. 900 N
Required max. drive torque	3.3 Nm	3.3 Nm

* In combination with motor 3133 and the LogicData controll box Compact-3

** Stroke length of 720 mm is constant at installation dimension between 476 mm and 560 mm

Technical notes

- The lifting units must be protected against lateral forces by a separate guide system.
- Attention: The spindle systems with a spindle pitch ≥ 3 mm may not be self-locking. Check the self-locking effect in the application.
- The lifting unit is only pressure loadable.
- Customer specific stroke and installation lengths available upon request.
- Incorrect dimensioning of the guide system can damage the lifting unit: Please note the design and safety instructions for spindle drives. You will find them at: [https:// www.ketterer.de/en/downloads/instructions](https://www.ketterer.de/en/downloads/instructions)

Variants 3130.14-V01EXXXHXXX

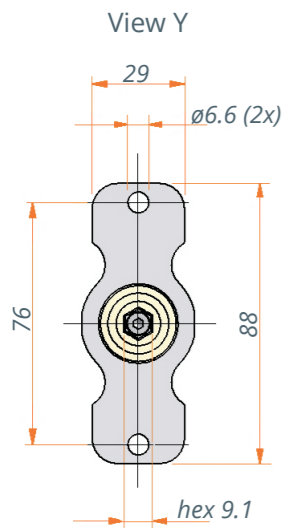
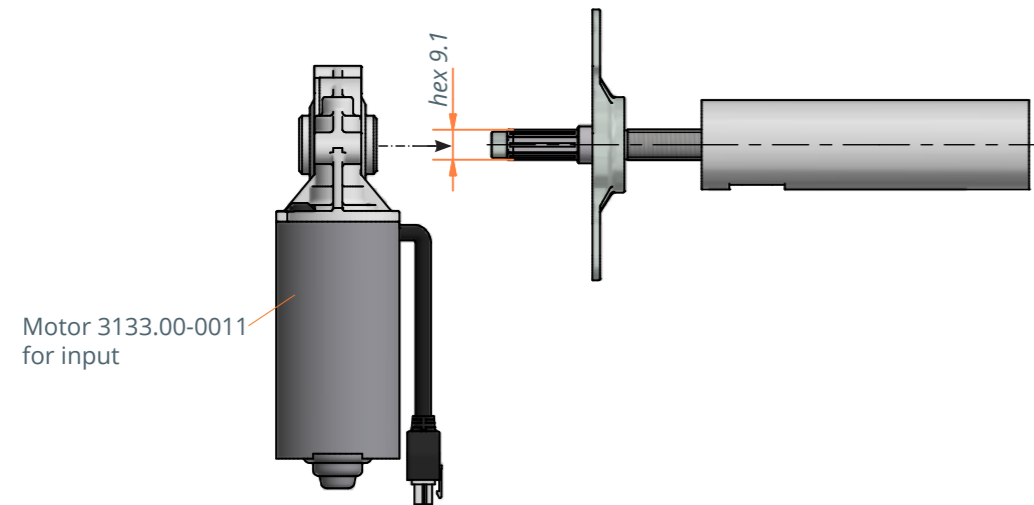
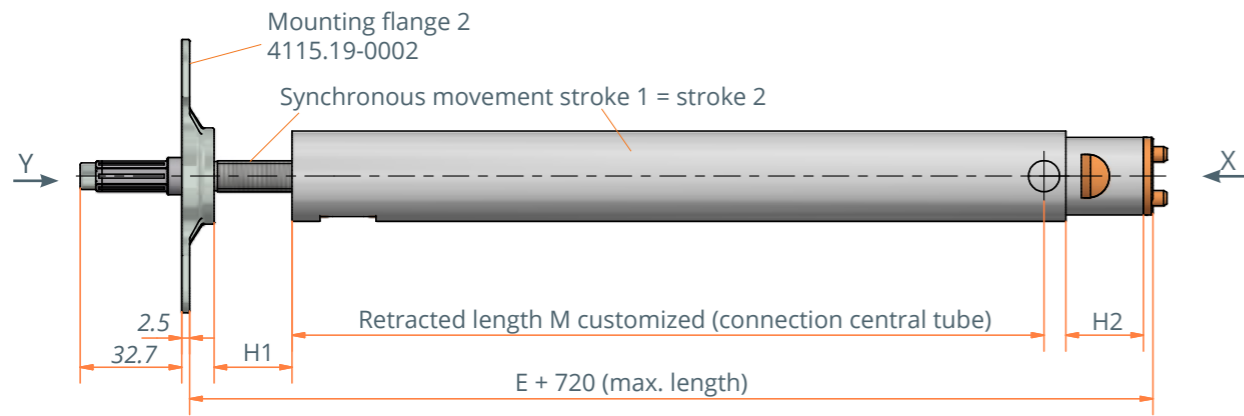

Variants 4115.14-V02EXXXMXXX

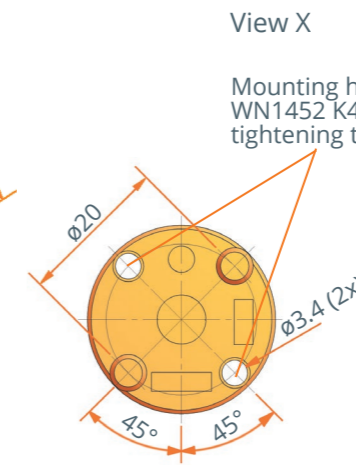
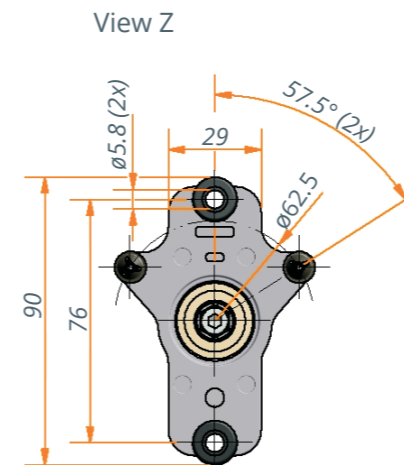
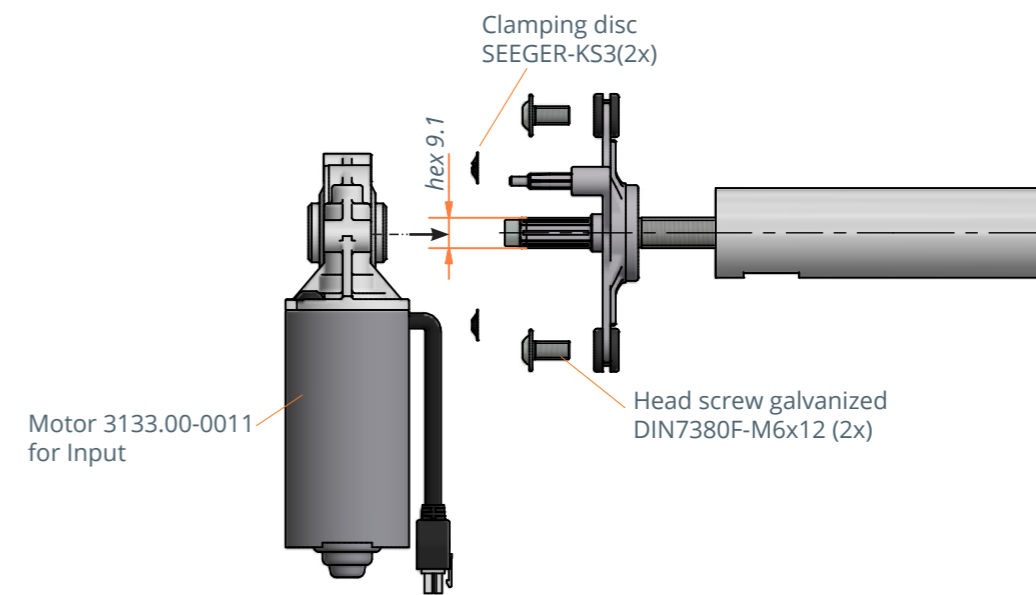
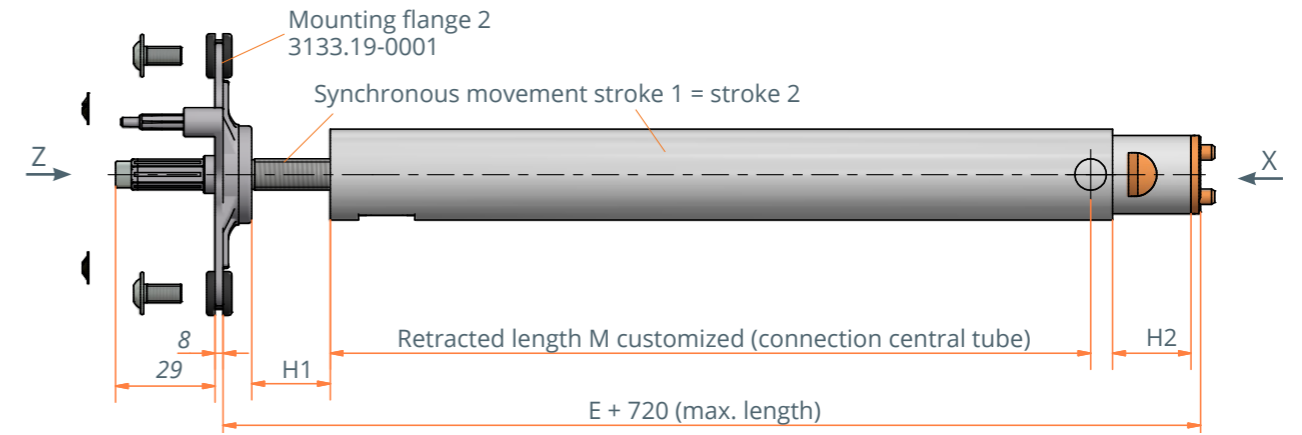

Mounting holes for screws
WN1452 K40x16
tightening torque 1.8 Nm

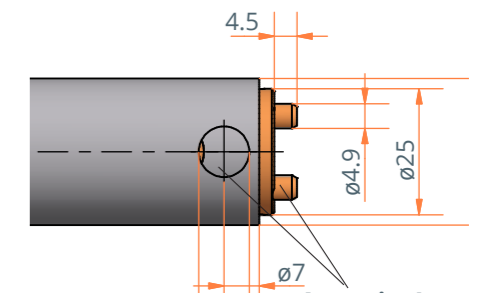

Attention!
Pin-position to borne
 $\phi 10$ must be considered